



B.O.S. LOCK FUSION

SAFETY, OPERATION, AND INSTALLATION MANUAL

FOR MODEL: BOS-FS1

Version/date: Manual Version 1.1 | May 2026

Company identification: Biometric Optimized Safety LLC (DBA B.O.S. Lock)

Patent Information can be found at: <https://boslock.com/patents/>

IMPORTANT NOTICES – READ BEFORE USE

⚠ WARNING **WARNING:** Read this manual in full before installing, programming, charging, or using the B.O.S. Lock Fusion. Failure to follow instructions may result in unauthorized access, accidental discharge, serious injury, or death.

⚠ WARNING **NOTICE:** This manual is intended to provide general product guidance only. It does not replace firearm safety training, legal advice, or professional instruction.

⚠ WARNING **LASER NOTICE:** This product contains a laser device. Avoid direct eye exposure. LED RADIATION (RG-2). DO NOT STARE INTO BEAM. MAY BE HARMFUL TO EYES. PER IEC 62471 ED 1.0:2006-07.

⚠ WARNING

LASER RADIATION;
AVOID DIRECT EYE EXPOSURE.
CLASS 3R LASER PRODUCT
510 - 530 nm, OUTPUT <5 mW



COMPLIES WITH
21CFR1040.10 & 11
LASER NOTICE 56
08 MAY 2019

TABLE OF CONTENTS

1. Company Mission and Vision Statement	4
2. Foundational Safety	5
3. Intended Use and Operating Limitations	6
4. What's Included	7
5. Product Identification and Control Points	9
6. Fingerprint Registration	10
7. Installation on Firearm Procedure	12
8. Familiarization	17
9. Operating Instructions and Controls	18
10. Laser Zeroing and Calibration	22
11. Battery Safety and Maintenance	22
12. Troubleshooting	23
13. Maintenance and Optical Care	24
14. Technical Specifications	24
15. Warranty Information	25
16. Regulatory and Legal Notices	31
17. Standard of Care and User Responsibility	32

1. COMPANY MISSION AND VISION STATEMENT

1.1 Mission Statement

B.O.S. Lock exists to redefine firearm safety through innovative technology that integrates seamlessly with modern firearms, giving responsible owners smarter ways to secure their firearms without sacrificing performance.

1.2 Vision Statement

At B.O.S. Lock, we have our sights set on a future where firearm security is an exact science. We aim to eliminate the 'shared secrets' of keys and codes, replacing them with biometric authentication so precise that your identity becomes the only firing pin. Our target is a world where unauthorized access is impossible.

1.3 Note From Our Founder

When I became an uncle, I found myself looking for a solution that didn't seem to exist. I wanted my firearms to be truly secured from my curious nephew's hands, but I also needed them ready the moment a threat became real. Every device I tried forced a compromise: you could have speed or safety, but not both.

I started **B.O.S. Lock** so that you would never have to make that choice.

By replacing keys and codes with technology that recognizes **you** specifically, we've removed the guesswork from security. Our goal is to make you more capable the moment you are needed, while providing complete peace of mind when you are not. Thank you for trusting us to help you protect what matters most.

– **Keith Bombaugh**, *Founder, B.O.S. Lock*



2. FOUNDATIONAL SAFETY

2.1 Save These Instructions

This manual contains important safety, operating, charging, maintenance, and product handling instructions for the B.O.S. Lock Fusion (“the device”).

2.2 Core Firearm Safety Rules

The B.O.S. Lock Fusion does not replace the fundamental rules of firearm safety:

- Treat every firearm as if it is loaded.
- Keep your finger off the trigger until ready to fire.
- Never point a firearm at anything you are not willing to destroy.
- Be sure of your target and what is beyond it.

2.3 Mandatory Safety Check Before Any Setup or Handling

Before programming, installing, adjusting, removing, charging near, or maintaining the device:

- Point the firearm in a safe direction.
- Remove the magazine.
- Lock the slide to the rear.
- Confirm the chamber is empty.
- Keep the breech open during installation and setup.

⚠ CAUTION The device is a supplemental safety product only. No accessory can eliminate the risks associated with firearm ownership, storage, transport, or use.

3. INTENDED USE AND OPERATING LIMITATIONS

3.1 Intended Use

The B.O.S. Lock Fusion is a user-authenticated firearm safety device intended for controlled residential and similar indoor environments.

Its purpose is to help restrict unauthorized operation by requiring successful fingerprint authentication before normal access.

3.2 Operating Limitations

- Compatibility varies by firearm model, Picatinny rail, and accessory rail design. Use only firearms and rail interfaces confirmed compatible by B.O.S. Lock.
- Not waterproof or submersible.
- Light exterior moisture may not affect function, but water ingress through openings may damage internal electronics.
- Not intended for use in combat or other scenarios with prolonged exposure to outdoor elements
- Not designed for prolonged exposure to severe outdoor conditions.
- Not intended to replace responsible firearm handling or professional training.

i NOTICE Product performance of the device may vary based on firearm configuration, mounting position, user technique, environmental conditions, battery condition, and maintenance. Never leave a loaded firearm unattended.

4. WHAT'S INCLUDED

4.1 Package Contents Overview

This section identifies the components supplied with the B.O.S. Lock Fusion. Package contents may vary by configuration and are subject to change. Verify all items are present before beginning installation or programming.

4.2 Components Supplied in the Box

The package is intended to include the following items:

- A. B.O.S. Lock Fusion device (1 unit)
- B. Programming tool
- C. Proprietary locking bolt
- D. Proprietary bolt driver
- E. M4 Retention Screws
- F. Laser Adjustment Allen Wrench
- G. Quick Start Guide and QR code to digital manual
- H. Resources from our partners
- I. B.O.S. Lock protective case

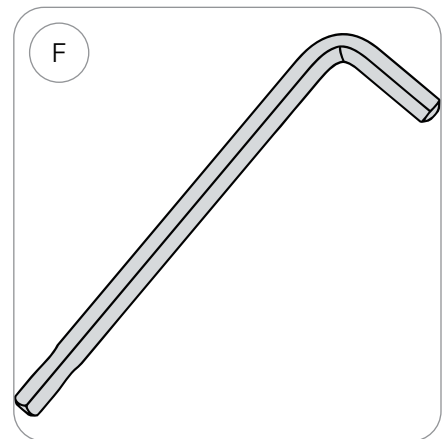
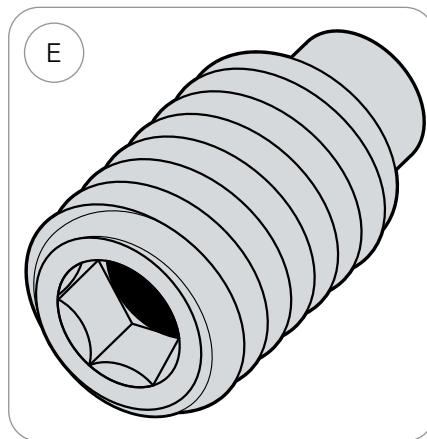
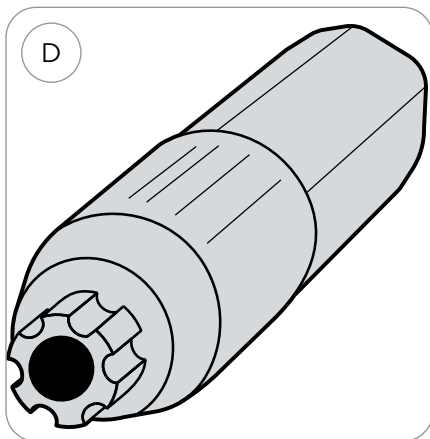
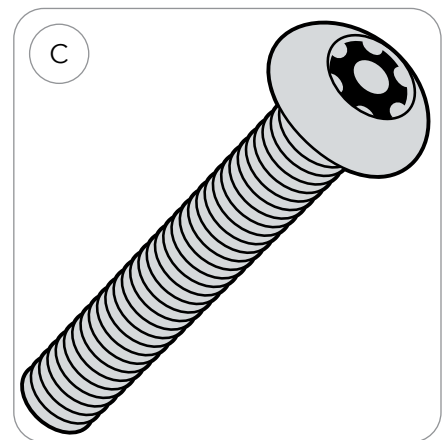
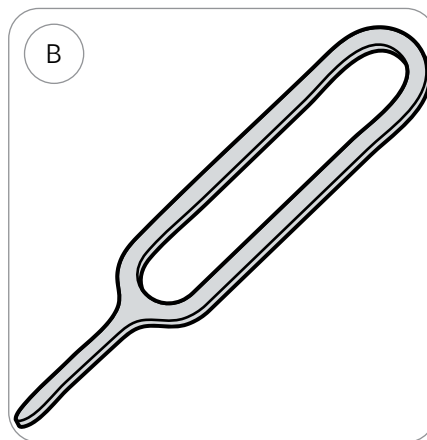
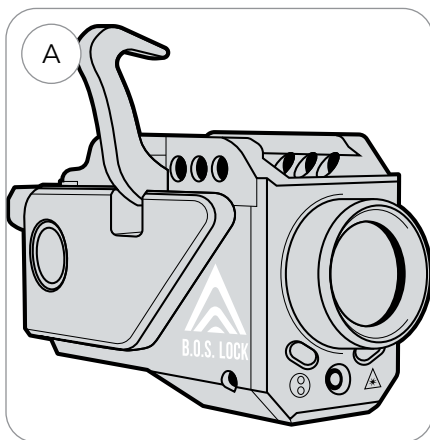

4.3 Items Not Supplied

The following items are not supplied unless explicitly listed in Section 4.2:

- Firearm
- Additional accessories not expressly identified as included

4.4 Inspection Prior to Use

Inspect all components upon opening the package. If any item is missing or appears damaged, do not proceed with installation. Contact B.O.S. Lock customer support at support@boslock.com for assistance.

5. PRODUCT IDENTIFICATION AND CONTROL POINTS

- A. Biometric sensor
- B. Retention arm
- C. A paddle
- D. B paddle (Biometric side of device)
- E. P Port
- F. C Port
- G. Mounting bolt hole locations
- H. LED light
- I. Windage adjustment point
- J. Elevation adjustment point
- K. USB-C charging port

Check out our quick install video for more information: boslock.com/compatibility/#video

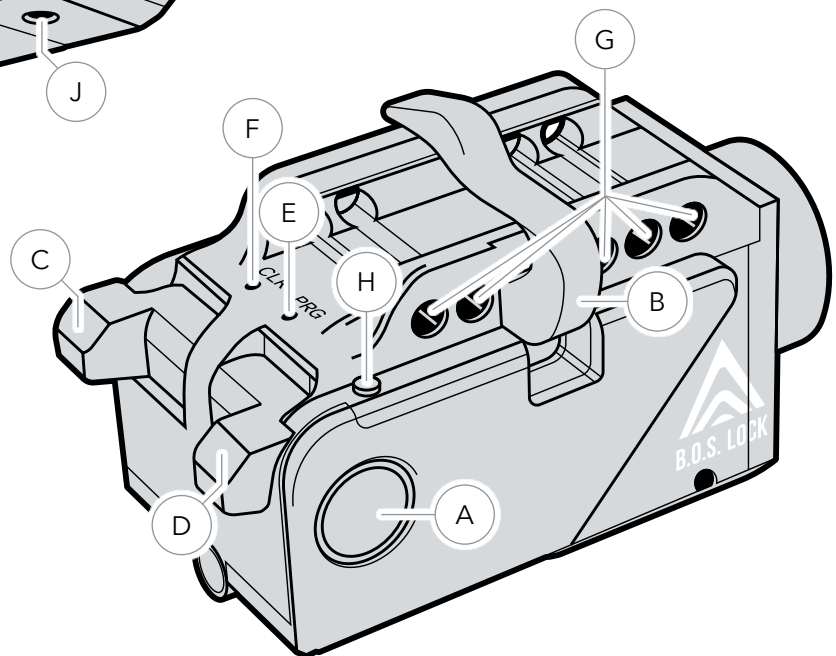
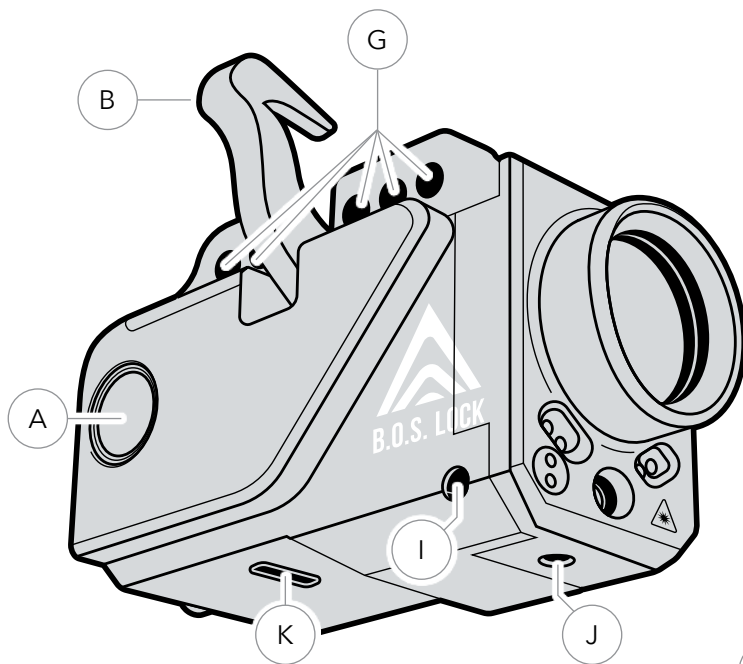

6. FINGERPRINT REGISTRATION

6.1 Fingerprint Registration Procedure

1. Insert the **programming tool** into the **P Port**.
2. Confirm the **LED light** is blinking blue.
3. Place the pad of the desired finger flat on the **biometric sensor** for about 1 second.
4. Lift the finger for about 1 second.
5. Repeat until the **LED light** flashes green, indicating the fingerprint has been successfully programmed.

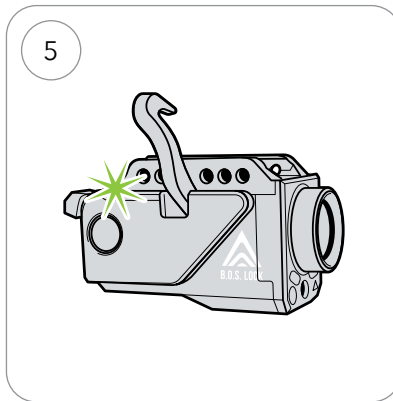
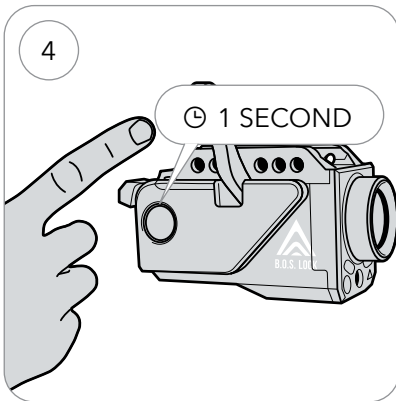
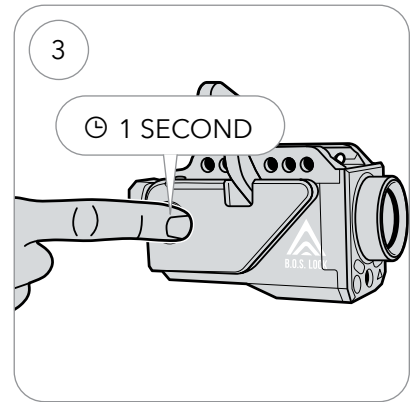
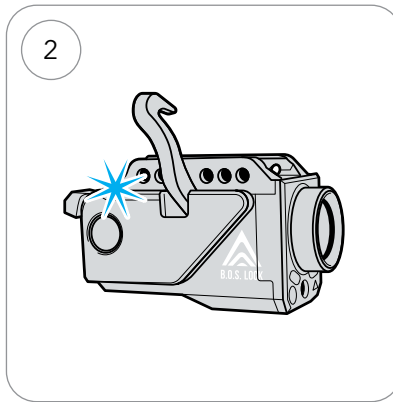
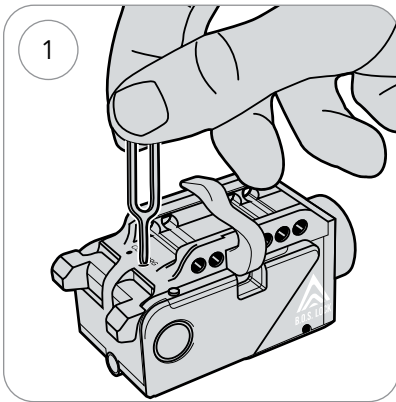

6.2 Registration Best Practices

- Begin with the finger most likely to be used during normal access.
- Keep the finger clean and dry during fingerprint registration.
- Center the fingerprint on the biometric sensor.
- Slightly rotate the finger between scans to capture print variation.
- Register additional fingers only after confirming reliable operation with the primary print.

i NOTICE Fingerprint recognition performance may be affected by moisture, debris, skin condition, injury, pressure, angle of contact, and placement consistency.

7. INSTALLATION ON FIREARM PROCEDURE

7.1 Pre-Installation Safety Requirements

Before installation:

- Point the firearm in a safe direction.
- Remove the magazine.
- Clear the chamber.
- Lock the slide to the rear.
- Confirm the firearm remains unloaded throughout installation.

7.2 Installation Steps

1. Authenticate and open the **retention arm**.
2. Slide the device fully onto the firearm rail.
3. Position the device as far rearward as possible by firmly pressing it into place while preserving safe and comfortable paddle access.
4. Align the **mounting bolt hole** with the appropriate rail slot of the firearm.
5. On the side of the Fusion opposite of the retention arm, thread the provided **proprietary locking bolt** through the housing and rail slot.
6. Hand-tighten only using the provided **proprietary bolt driver**.
7. On the side of the Fusion opposite of the locking bolt, thread the provided **M4 Retention Screw** into the designated hole and hand-tighten until snug.
8. Tighten the set screw as needed to prevent movement.
9. With the slide of the firearm locked to the rear, push the **retention arm** into position until it locks.

[Check out our quick install video for more information: boslock.com/compatibility/#video](https://boslock.com/compatibility/#video)

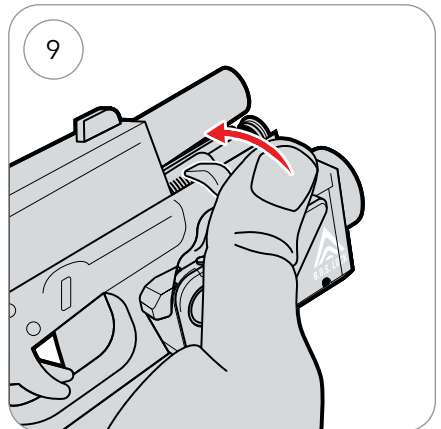
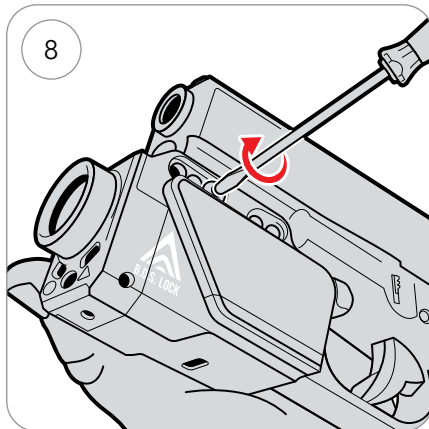
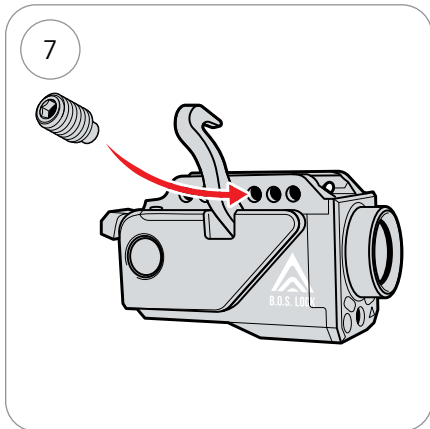
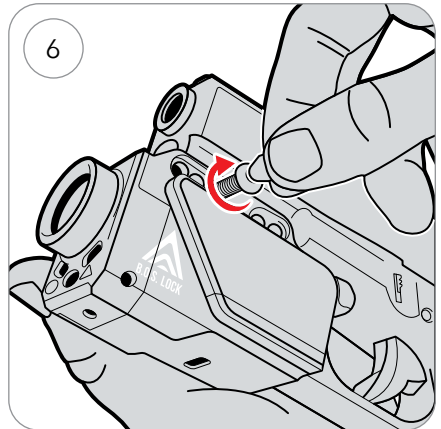
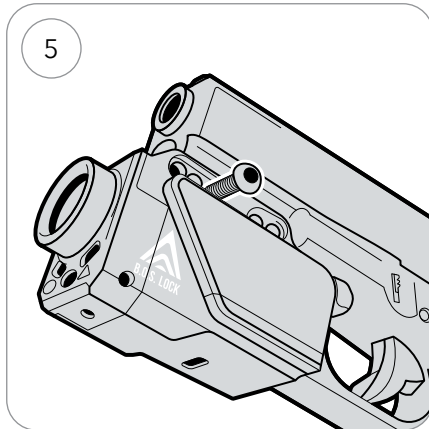
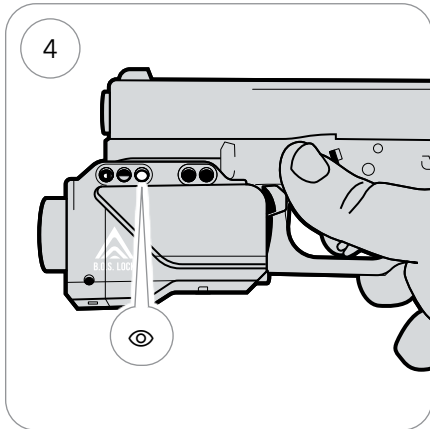
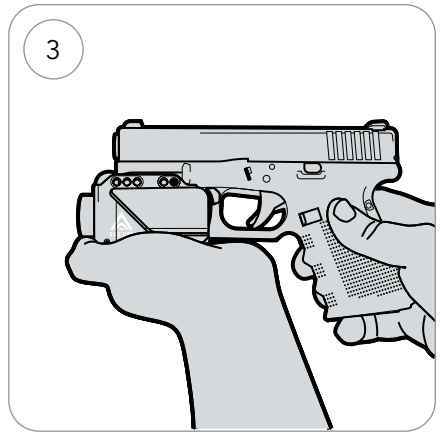
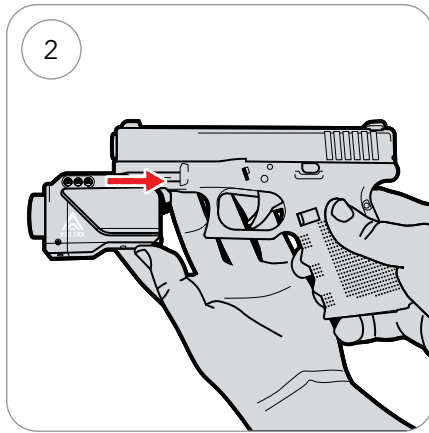
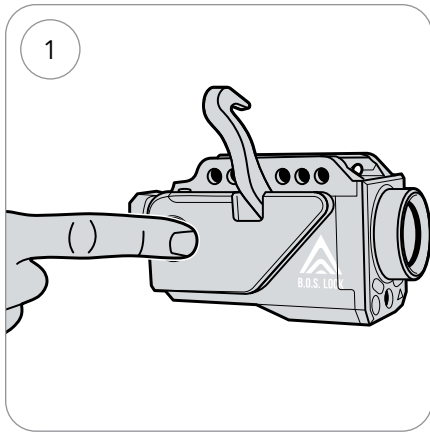

IMPORTANT: Mounting Torque Specification

To ensure a secure mount without damaging the firearm or the B.O.S. Lock hardware, please follow these specific torque guidelines.

1. The Metric Limit

- Target Torque Setting: 0.5 Nm. (approximately 4.4lb-in.)
- Maximum: 0.5 Nm.
- WARNING: Do not exceed this limit. Standard M4 torque settings or tightening with a full-palm grip or power tools will apply excessive force, immediately stripping the mounting threads.

2. Threadlocker (HIGHLY ADVISED)

- Because 0.5 Nm is a light torque setting, the use of a threadlocking compound is highly advised to ensure the hardware remains secure under the vibration and recoil of fire. Without threadlocker, the screw may back out over time.
- Recommended: Medium-strength (Blue) threadlocker.
- Application: Apply one small drop to the screw threads before installation.
- Cure time: For maximum security, allow 24 hours for the compound to fully cure before taking the firearm to the range.

3. Manual Installation (The "Two-Finger" Rule)

- If a precision torque driver calibrated to 0.5 Nm is not available:
 - Thread the screw in until the head is flush.
 - Grip the screwdriver handle using only your thumb and index finger.
 - Turn until you feel the very first sign of resistance, then stop. Do not "crank" the screw.

For Complete Stability: Take the provided brass-tipped M4 set screw and tighten by hand into the designated hole on the opposite side (arm side) of the firearm.

7.3 Installation Restrictions

- Use only the provided hardware and driver.
- Do not use power tools.
- Do not modify the housing, hardware, or firearm rail.
- Stop installation if fitment appears improper or forced.

⚠ WARNING Improper installation may reduce product performance or create unsafe conditions.

COMPATIBILITY AND FITMENT NOTICE

- The B.O.S. Lock Fusion is compatible with most striker-fired handguns, provided the firearm has an attachment rail for mounting. It is not compatible with revolvers.
- Do not install on modified, damaged, or out-of-spec rails.
- Before live use, confirm the device is secure and does not shift.
- For supported models, refer to the Compatibility List at: boslock.com/compatibility

7.4 Settings Mode

The device supports a settings mode for authorized users.

ENTER SETTINGS MODE

1. Press and hold both the **A paddle** and **B paddle** for 5 seconds.
2. Confirm the **LED light** is blinking purple rapidly.
3. Tap an authorized fingerprint on the **biometric sensor**.
4. Once recognized, confirm the **LED light** becomes solid purple.

Subsequent changes will apply to the authenticated fingerprint profile.

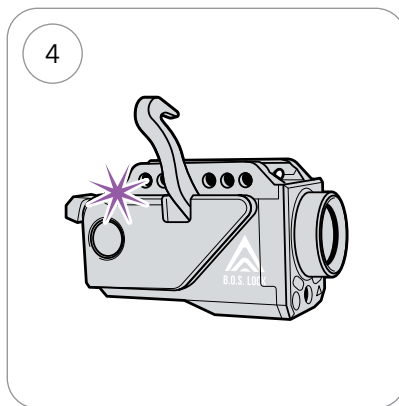
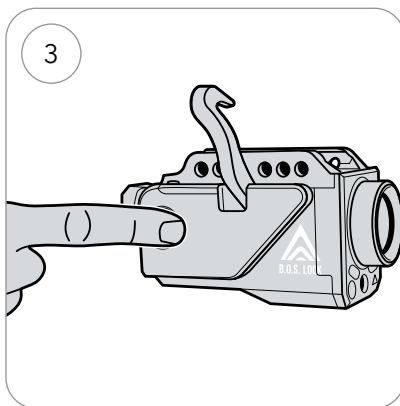
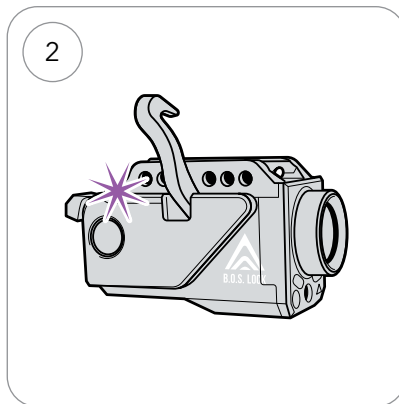
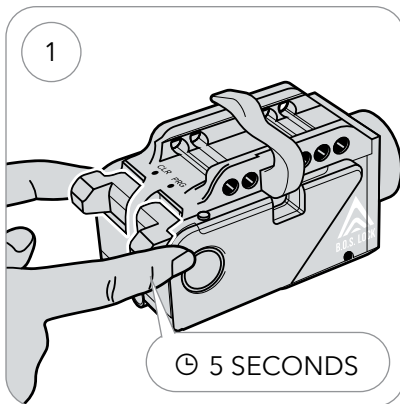

OPTIONAL CUSTOM USER PRESET SETTINGS

Custom preset settings for each user may be programmed for an authorized fingerprint.

Preset Configuration Steps

1. From the solid purple settings state, double tap the **A paddle**.
2. Confirm the **LED light** alternates between purple and yellow.
3. Double tap the **A paddle** again to enter preset configuration.
 - While present configuration is active:
 - Single tap the **A paddle** to cycle between light settings.
 - Double tap the **B paddle** to toggle the laser on or off.
4. Hold both **paddles** for 5 seconds to save custom settings and exit Settings Mode.

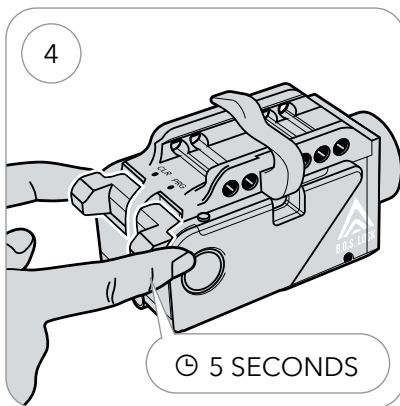
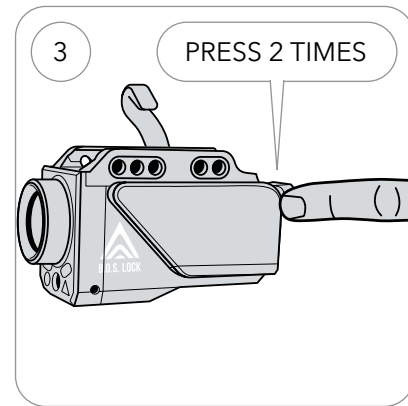
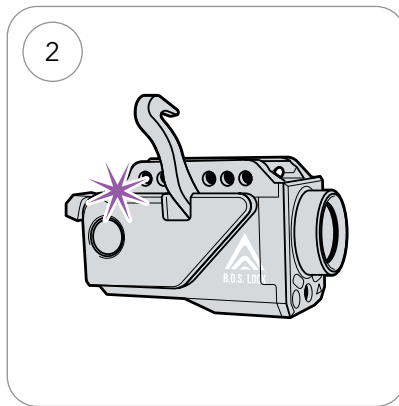
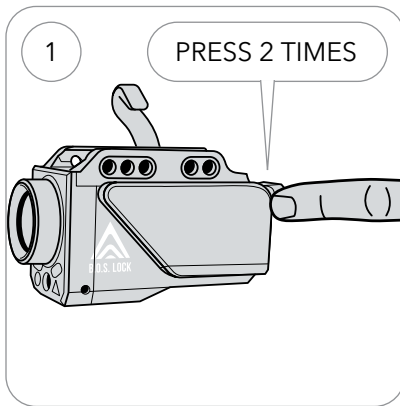

7.5 Removal / Uninstallation Procedure

⚠ WARNING Before removing the device, follow the [Mandatory Safety Check \(Section 2.3\)](#). Confirm the firearm is unloaded, the magazine is removed, and the slide is locked to the rear and not sitting on the Retention Arm.

1. Take the **proprietary bolt driver** and remove the **proprietary locking bolt**.
2. After the locking bolt is removed, loosen the **M4 Retention screw** on the other side (arm side) of the device.
3. Once the **M4 Retention screw** is loosened, slide the Fusion off of the firearm.

i NOTICE Do not use power tools for removal. If hardware is stripped, damaged, or cannot be removed using normal hand force, discontinue and contact B.O.S. Lock customer support.

8. FAMILIARIZATION

8.1 Localized Device Operation and Data Storage

The B.O.S. Lock Fusion is designed to operate as a self-contained device.

- No Wi-Fi connection is required.
- No Bluetooth connection is required.
- No cloud account or cloud storage is required for normal operation.
- Fingerprint data and user settings are stored locally on the device.

8.2 Initial Familiarization

Before relying on the device, users should complete repeated dry practice runs with an unloaded firearm.

Recommended familiarization:

- Confirm the firearm is unloaded, the chamber is empty, and the breech is open.
- Practice acquiring a proper grip while maintaining trigger discipline.
- Practice placing the registered finger naturally on the sensor.
- Practice accessing the paddles and sensor without shifting into an unsafe grip.

- Repeat dry runs until operation is consistent and deliberate.

8.3 Ongoing Familiarity

Regular use of the biometric scanner may help maintain familiarity with fingerprint placement and the device response.

NOTICE Users remain responsible for obtaining competent firearm safety training and for practicing safe handling at all times.

9. OPERATING INSTRUCTIONS AND CONTROLS

9.1 Retail Demo Mode

When no fingerprints are programmed, the unit may operate in demo mode.

1. Press and hold the B paddle for 3 seconds to enter “open” demo mode.
2. Confirm the LED light is blinking yellow.
 - In this state, any fingerprint interaction may unlock the B.O.S. Lock Fusion.
3. Press and hold the B paddle for 3 seconds again to return to “secure” demo mode.
4. Confirm the LED light flashes yellow 3 times.
 - In this state, the B.O.S. Lock Fusion will not unlock with fingerprint interaction.

NOTICE Once a fingerprint is programmed, demo mode is disabled until the unit is factory reset.

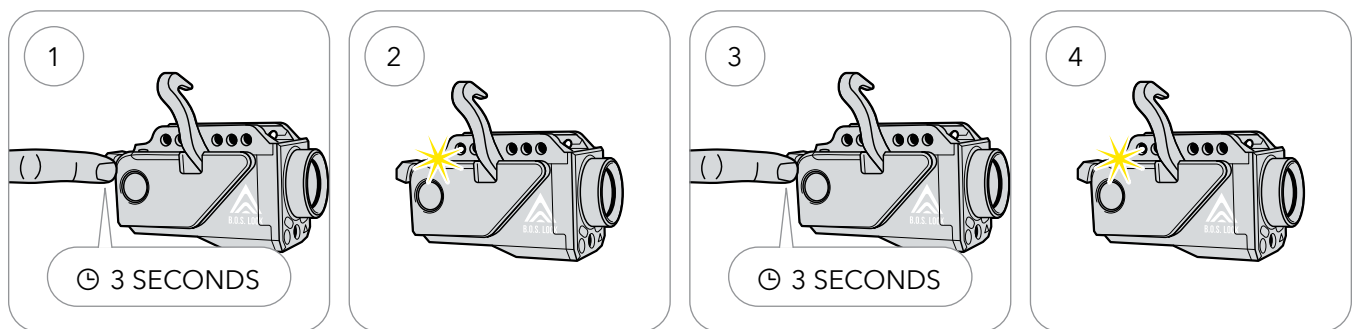

9.2 Quick Operation Reference

- A. **Biometric Sensor:** Authorized touch unlocks the retention arm.
- B. **A Paddle:** Controls light settings.
- C. **B Paddle:** Controls laser settings.
- D. **P Port:** Fingerprint registration mode.
- E. **C Port:** Factory reset and memory clearing. See [Section 9.4](#).

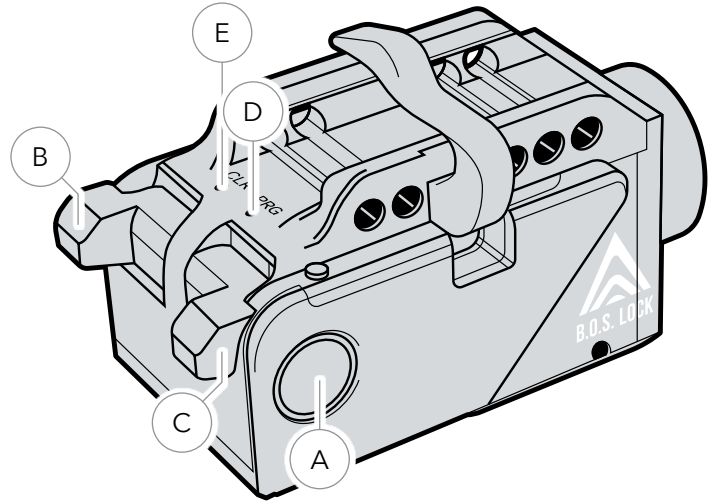

9.3 Voluntary Self-Authorized Lockout

The Voluntary Self-Authorized Print Lockout allows a programmed user to temporarily disable one authorized fingerprint for 48 hours.

⚠ WARNING: VOLUNTARY LOCKOUT IS NOT EMERGENCY PROTECTION.

SELF-AUTHORIZED LOCKOUT ACTIVATION PROCEDURE

1. Enter Settings Mode. ([Section 7.4](#))
2. While in Settings mode, press the **B paddle**.
3. The **LED light** will alternate red and yellow.
4. Tap the fingerprint you wish to lock out on the **biometric scanner**.
5. The **LED light** will flash red rapidly.
6. Tap the **B paddle** again.
7. Confirm the **LED light** becomes solid red.
8. Tap the same fingerprint on the **biometric scanner** again to authorize the lockout.
9. The fingerprint is now unauthorized for 48 hours.

⚠ WARNING: VOLUNTARY LOCKOUT IS NOT EMERGENCY PROTECTION.

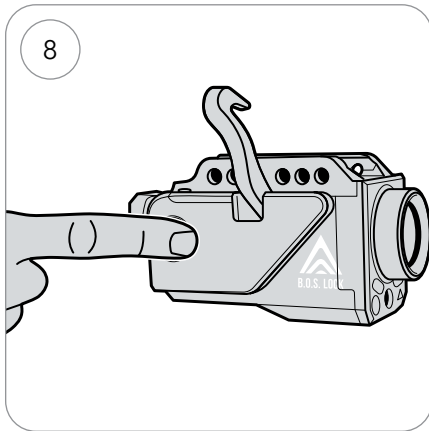
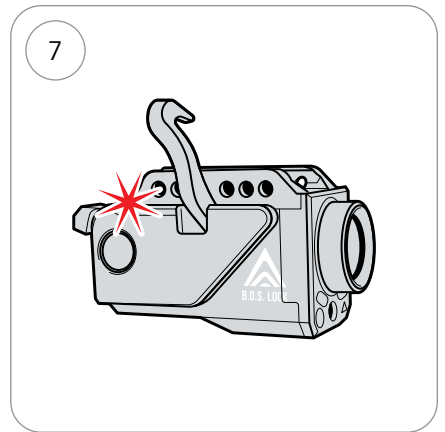
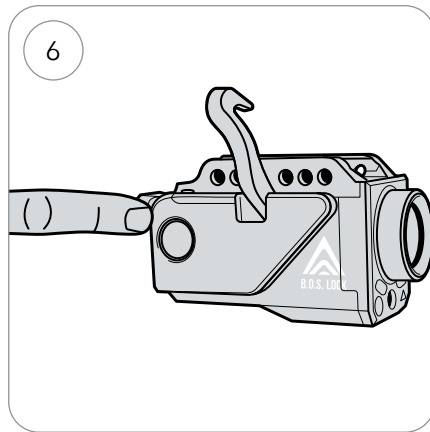
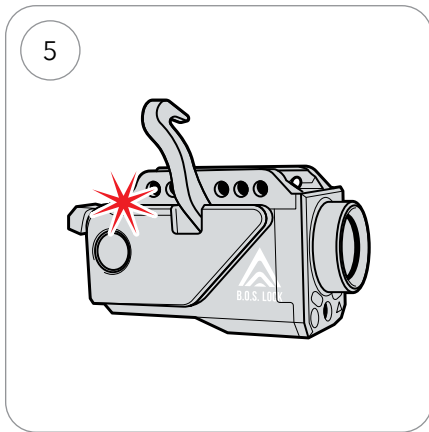
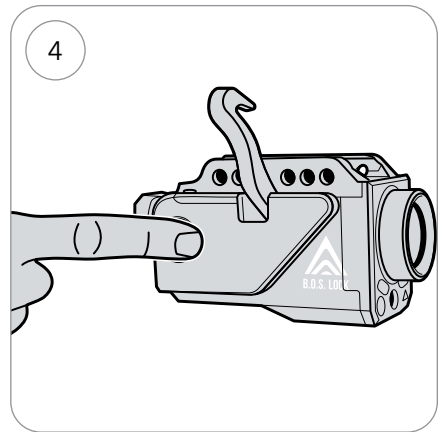
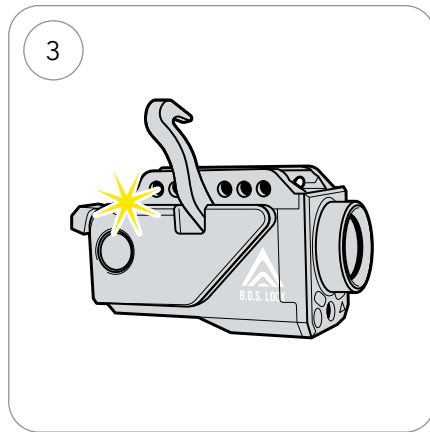
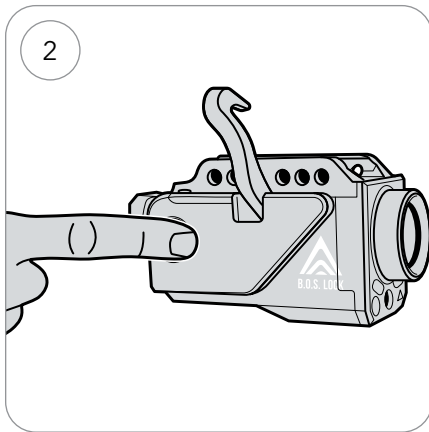

IMPORTANT NOTICE:

The Voluntary Self-Authorized Lockout ("the feature") is intended only as a voluntary, user-initiated delay feature for an already authorized user.

It is NOT: a medical device, a crisis intervention service, a substitute for professional mental health treatment, or a guarantee against self-harm, violence, unauthorized access, or injury.

LIMITATION OF LIABILITY

To the maximum extent permitted by applicable law, B.O.S. Lock and its affiliates disclaim responsibility for injury, death, self-harm, misuse, delayed access, or other loss occurring during or after activation of the Voluntary Self-Authorized Lockout.

By activating the feature, the user acknowledges that they are voluntarily restricting their own access and that the feature may delay access in urgent circumstances.

EMERGENCY OVERRIDE NOTICE

In the event of accidental lockout, restoring access may require manual removal of the device using the proprietary tool, followed by reset and reprogramming procedures.

This process is intentionally not immediate.

If there is an immediate risk of self-harm or harm to others, contact emergency services or the [988 Suicide and Crisis Lifeline](#).

9.4 Factory Reset and Memory Clearing (C Port)

Factory reset clears stored fingerprint profiles and user settings. Use this procedure before transfer, troubleshooting, or if a reset is required for service.

⚠ WARNING Perform this procedure only after removing the device from the firearm.

FACTORY RESET PROCEDURE

1. On the bottom of the device, insert the **Programming tool** into the **C port**.
2. Press and hold for 5 seconds until the **LED light** flashes. The flashing indicates that the entire fingerprint memory has been successfully cleared from the device.

i NOTICE Factory reset permanently deleted stored fingerprint profiles and user settings. B.O.S. Lock cannot recover deleted fingerprint data.

10. LASER ZEROING AND CALIBRATION

10.1 General Guidance

The laser is factory-centered but should be adjusted by the user to match the firearm and preferred point of aim.

10.2 Adjustment Points

- A. **Windage adjustment** is located on the side of the housing.
- B. **Elevation adjustment** is located on the bottom of the housing.

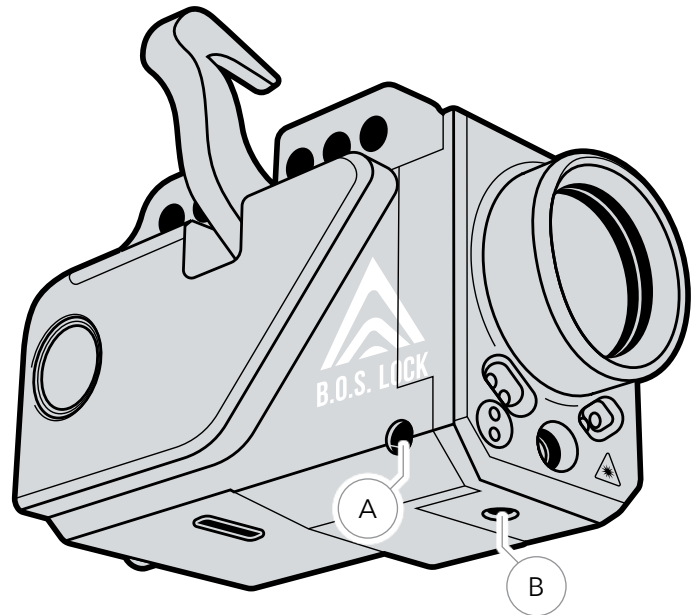

10.3 Calibration Procedure

1. Confirm the firearm is unloaded before adjustment.
2. Use the provided laser adjustment allen wrench to adjust the laser.
3. Verify alignment at the user's chosen distance.
4. Recheck alignment after installation changes or impact.

NOTICE Final adjustment direction labels and laser specifications should match the approved production model.

11. BATTERY SAFETY AND MAINTENANCE

11.1 General Battery Safety

The B.O.S. Lock Fusion uses a lithium-polymer battery.

11.2 Battery Precautions

- Do not charge the device below 32°F.
- Do not expose the device to extreme heat.
- Stop using the device if the housing is severely crushed, deformed, or damaged.
- For long-term storage over 30 days, maintain a partial charge.

11.3 Low-Battery Behavior

Low battery conditions may limit manual light or laser functions before biometric release functions are affected.

⚠ WARNING Damaged lithium-polymer batteries may present fire, heat, or failure hazards.

12. TROUBLESHOOTING

12.1 Common Issues

- **Fingerprint denied:** Clean and dry the finger, then retry with proper placement on the biometric scanner.
- **No response:** Recharge the B.O.S. Lock Fusion.
- **Light or laser not staying on:** Check battery level and inactivity timeout behavior.
- **Cannot enter settings mode:** Repeat the Settings Mode sequence and hold controls for the full required time.
- **Laser alignment changes:** Check mounting tightness.
- **Paddles unresponsive:** Recharge the device and inspect for low-battery safeguard behavior.

12.2 Service Notice

If the B.O.S. Lock Fusion appears damaged, does not mount correctly, or does not operate as expected after following this manual, discontinue use until inspected or serviced in accordance with the company's warranty policy. To request services, please email us at support@boslock.com. If service is required, remove the device using the steps outlined in [Section 7.5](#) before shipping or returning.

13. MAINTENANCE AND OPTICAL CARE

- Keep the biometric sensor clean and dry.
- Clean optical surfaces with a soft, non-abrasive cloth.
- Do not use harsh chemicals or abrasive materials.
- Inspect mounting hardware regularly.
- Recharge the B.O.S. Lock Fusion as needed to maintain readiness.
- If the device has been exposed to water ingress or impact damage, discontinue use until inspected.

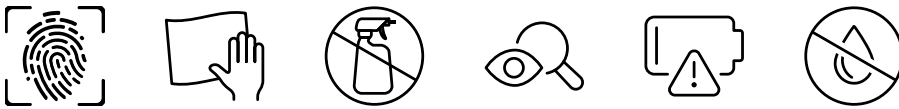

14. TECHNICAL SPECIFICATIONS

BIOMETRIC ENGINE

- **Recognition Speed:** < 0.25 seconds (from contact to mechanical release).
- **Storage:** 20 Unique Fingerprint Profiles.
- **Security:** Air-Gapped / Zero Network Connectivity.

LIGHT SPECS

- **Peak Output:** 700 Lumens (Turbo/Strobe).
- **Modes:** 15 Lm (Low) / 450 Lm (Med) / 700 Lm (High).
- **Candela:** 6,000cd.

LASER SPECS

- Class 3R Green Laser (<5mW).

MECHANICAL & ENVIRONMENTAL

- **Chassis:** Precision-machined 6061-T6 Anodized Aluminum.

- **Locking Mechanism:** High-Tensile DLC Coated Steel Arm.
- **Weight:** 5.4 oz.
- **Thermal Range:** -20°F to 140°F (Operational).
- **Tensile Load:** 300 lbs.
- **Impact Resistance:** 1-Meter drop test rated.

15. WARRANTY INFORMATION

Effective Date: 12.6.2025

Applicability: All B.O.S. Lock Products (Past, Present, & Future)

At B.O.S. Lock, we stand behind the quality, reliability, and durability of every product we create. Our mission is to deliver security solutions that offer both peace of mind and rapid access when you need it most.

We believe that customers who join our community deserve the highest level of protection. Therefore, we offer two distinct levels of warranty coverage. Both options are included with your purchase and are completely free of charge.

15.1 The Two Paths to Coverage

You automatically receive our Standard Warranty with every purchase. However, by taking a moment to register your device, you unlock Elite Status, upgrading your coverage to match and exceed industry standards at no cost to you.

COVERAGE FEATURE	STANDARD (UNREGISTERED)	EXTENDED (REGISTERED)
Cost	FREE	FREE
Requirement	Proof of Purchase only	Register within 30 days of purchase
Electronics & Laser	1 Year	2 Years (Matches Industry Leaders)
Mechanical & Housing	3 Years	Lifetime
Repair Service	Available (Cost + Labor)	Available (Cost + Labor)
Replacement Benefit	Discounted Retail Price	"Cost +" Pricing (No Markup)
Priority Support	Standard Queue	Priority Handling

15.2 Path A: B.O.S. Lifetime Status (Recommended)

How to Qualify: Register your product at <https://boslock.com/registration/> within 30 days of purchase. (Registration is free and takes less than 2 minutes).

By registering, you activate our maximum level of protection and loyalty benefits:

- **Limited Lifetime Mechanical Warranty:** The structural housing, mounting interface, and internal locking mechanisms are warranted to be free of defects for the lifetime of the original owner.
- **2-Year Electronics Warranty:** The laser diode, internal circuitry, and activation switches are covered for two (2) years from the date of purchase.
- **"Cost +" Replacement Protection:** If your unit is ever damaged beyond repair (even due to accidental uncovered damage), you are eligible to replace it with a new unit at our

Manufacturer's Cost + Handling rate.

- **Priority Processing:** Warranty claims for registered devices are fast-tracked in our service queue.

15.3 Path B: Standard Warranty

How to Qualify: Simply retain your original receipt or proof of purchase.

If you choose not to register, your product is still protected by our solid Standard Warranty:

- **3-Year Limited Mechanical Warranty:** The core mechanical hardware is covered against defects for three (3) years from the date of purchase.
- **1-Year Comprehensive Warranty:** All components, including electronics, lasers, and switches, are covered for one (1) year from the date of purchase.

15.4 Lifetime Repair & Replacement Policy (Post-Warranty Support)

We build our products to be serviced, not thrown away. If your B.O.S. Lock is damaged outside of the warranty period (or due to accidental uncovered damage), we offer two solutions:

OPTION 1: COST + LABOR REPAIR

For most issues, we offer a transparent repair service.

- **No Parts Markup:** You pay exactly what we pay for the replacement part.
- **Fair Labor:** You are billed a flat, transparent labor rate for the repair time.

OPTION 2: THE "COST +" REPLACEMENT (ELITE EXCLUSIVE)

Sometimes, a unit is simply too damaged to save, or the model is obsolete (Legacy Products).

- If we cannot repair your unit, Elite Status members may purchase a brand-new unit (of the equivalent current model) at our **Manufacturer's Cost + Handling rate**.
- **The Definition:** This price is calculated based on our raw manufacturing and shipping & operational handling costs, with zero retail markup.

15.5 Self-Defense Use Replacement Policy

If you are forced to use your firearm equipped with a B.O.S. Lock product in a self-defense situation, it is possible that your firearm and attached accessories will be taken into evidence and temporarily or permanently lost.

We stand by those who lawfully defend themselves.

- **The Pledge:** If your use of the firearm is deemed legally justified to the satisfaction of B.O.S. Lock, but your product is not returned to you, **we will replace your B.O.S. Lock product free of charge.**
- **Applicability:** This policy applies to all civilian self-defense scenarios. It also extends to Law Enforcement Officers for any legally justified use of force, whether on-duty, off-duty, or at home, provided the product was personally purchased by the officer.
- **Process:** Simply provide a copy of the police report or official documentation indicating the loss of the item during a lawful defensive encounter.

15.6 Terms & Conditions (Legal Liability)

- **Proof of Purchase:** A valid order number or receipt is required for all claims. (Waived if product is registered and enrolled as part of the elite program).
- **Original Owner:** Warranties are non-transferable and apply only to the original purchaser.
- **Exclusions:** This warranty covers manufacturing defects. It does not cover damage caused by theft (outside of Section 5), loss, normal cosmetic wear, battery leakage, abuse, misuse, or unauthorized modification. **Specific exclusions include:**
 - Careless or abusive handling, installation of aftermarket components, alterations or modifications, including those of a cosmetic nature, or failure to perform proper maintenance in accordance with the User Manual.
 - Criminal misuse, negligence, or use while under the influence of drugs or alcohol.

LIMITATION OF LIABILITY

Under no circumstances shall B.O.S. Lock be responsible for incidental or consequential damages with respect to economic loss, injury, death or property damage, whether as a result of breach of this warranty, negligence or otherwise.

ASSUMPTION OF RISK

Users accept the inherent risks associated with firearm ownership. While B.O.S. Lock devices

are rapid-access firearm safety tools designed to protect against unauthorized access, users acknowledge that any security method can be breached given sufficient time, tools, and determination.

BINDING ARBITRATION & CLASS ACTION WAIVER

All disputes, controversies, or claims arising out of or relating to this product or warranty shall be settled by binding arbitration. You agree to waive your right to a trial by jury and to participate in any class action lawsuit against B.O.S. Lock.

GOVERNING LAW & VENUE

This warranty and any disputes shall be governed by the laws of the State of Florida, without regard to its conflict of law principles. You agree that any arbitration, legal action, or proceeding shall be conducted exclusively in the state and county where B.O.S. Lock's principal headquarters is located.

SEVERABILITY

If any provision of this warranty is found to be unenforceable or invalid, that provision shall be severed, and the remainder of this warranty shall remain in full force and effect.

15.7 Regulatory & Safety Warnings

EXPORT CONTROL NOTICE (ITAR/EAR)

B.O.S. Lock products may contain advanced laser and night-vision compatible technologies that are subject to the International Traffic in Arms Regulations (ITAR) or the Export Administration Regulations (EAR). **Export of regulated products outside of the United States without a valid license or exemption from the U.S. Department of State or U.S. Department of Commerce is strictly prohibited.** By purchasing this product, you agree to comply with all applicable export laws.

BATTERY SAFETY & LIABILITY

Your device may utilize high-performance batteries (e.g., Lithium-Polymer, Lithium-Ion). Misuse, damage, or improper charging of these batteries can result in fire, explosion, or chemical burns.

- **Disclaimer:** B.O.S. Lock is not liable for any damage or injury resulting from the modification, puncture, or improper charging of the battery system.
- **Requirement:** Only use the provided charging cables or manufacturer-approved power sources. Never attempt to remove or replace internal non-user-serviceable batteries yourself.

CALIFORNIA PROPOSITION 65 WARNING

⚠ WARNING B.O.S. Lock products can expose you to chemicals including [Nickel (Metallic)], which is known to the State of California to cause cancer and birth defects or other reproductive harm. For more information go to www.P65Warnings.ca.gov.

15.8 Online 30-Day Money-Back Guarantee

We want you to be fully confident in your purchase. We offer a 30-day money-back guarantee for all products purchased directly from B.O.S. Lock.

- **The Terms:** If you are unsatisfied, you may return the product within 30 days of the delivery date for a full refund of the purchased price.
- **Condition:** The product must be returned in its original, like-new condition, including all packaging and accessories.

15.9 How to Submit a Claim or Return

To initiate a warranty claim, self-defense replacement, or return, please contact our Customer Support Team.

- **Email:** support@boslock.com
- **Subject Line:** "Warranty Claim - [Order Number]"

PLEASE INCLUDE THE FOLLOWING IN YOUR EMAIL:

1. Your full name and order number.
2. A detailed description of the issue.
3. Preferred Contact Phone Number

16. REGULATORY AND LEGAL NOTICES

16.1 General Legal Notice

This product is a supplemental safety device only. It does not eliminate the inherent risks associated with firearms.

16.2 User Responsibility

The user remains solely responsible for safe firearm handling, lawful storage, lawful transport, lawful use, and compliance with all applicable local, state, and federal laws.

16.3 Laser Notice Expand

Do not point the laser at aircraft, vehicles, or persons except as permitted by law.

Avoid direct eye exposure.

16.4 Compliance Notice

Any state-specific certification, approval, testing result, or compliance claim should be published only after formal verification.

16.5 Legal Review Notice

This manual should be reviewed by qualified legal counsel before final publication, especially with respect to safe-storage claims, certification references, mental health lockout language, battery liability language, and any indemnity or warranty provisions.

17. STANDARD OF CARE AND USER RESPONSIBILITY

17.1 Performance and User Responsibility

The B.O.S. Lock Fusion is a precision-engineered biometric security system. To ensure the integrity and reliability of the device, the User must strictly adhere to the following operational requirements:

- **Verified Fitment:** Optimal performance is contingent on the device being mounted on compatible firearm rails using the provided hardware and specific torque values.
- **Installation Integrity:** The Company is not liable for performance issues or mechanical failures resulting from installation that deviates from the instructions in Section 7.
- **Mandatory Safety Checks:** Users must perform a manual verification of the locking mechanism and mounting stability while the firearm is unloaded after every installation, adjustment, or removal.

17.2 Access Management and Authorized Users

The B.O.S. Lock Fusion allows for the programming of up to 20 unique biometric profiles.

- **Primary User Responsibility:** The Primary User (owner) acts as the sole administrator of the device and is fully responsible for the selection, vetting, and programming of any additional authorized users.
- **Assumption of Risk:** By granting biometric access to another person, the Primary User acknowledges and accepts full responsibility for that individual's conduct, firearm handling, and compliance with all safety protocols.
- **Liability for Authorized Access:** The Company disclaims responsibility for any injury, death, or misuse occurring as a result of actions taken by an individual who was granted authorized access by the Primary User.

17.3 System Integrity and Tampering

The B.O.S. Lock Fusion is an integrated security solution; its protective features rely on the physical and digital integrity of the unit.

- **Unauthorized Modification:** Any attempt to modify, alter, or service the Product using non-approved tools or hardware will compromise the system and void all performance expectations.
- **Physical Tampering:** The Company is not responsible for breaches or failures occurring as a result of intentional tampering or use of the Product beyond its intended design.

17.4 Supplemental Safety and Legal Status

The B.O.S. Lock Fusion is an advanced supplemental safety device.

- **Not a Total Guarantee:** While designed to restrict unauthorized operation via fingerprint authentication, it is not an absolute guarantee against unauthorized access or firearm discharge.
- **Core Safety Rules:** The device does not replace the fundamental rules of firearm safety. The User remains solely responsible for the safe handling, lawful storage, and compliance with all state and federal regulations regarding firearm safety devices.
- **Data Hygiene:** Users must follow the provided data-deletion and factory-reset (C Port) procedures when transferring ownership or returning the device to ensure biometric privacy.